

LED PANEL LIGHT

295*1195*35mm

140
lm/W

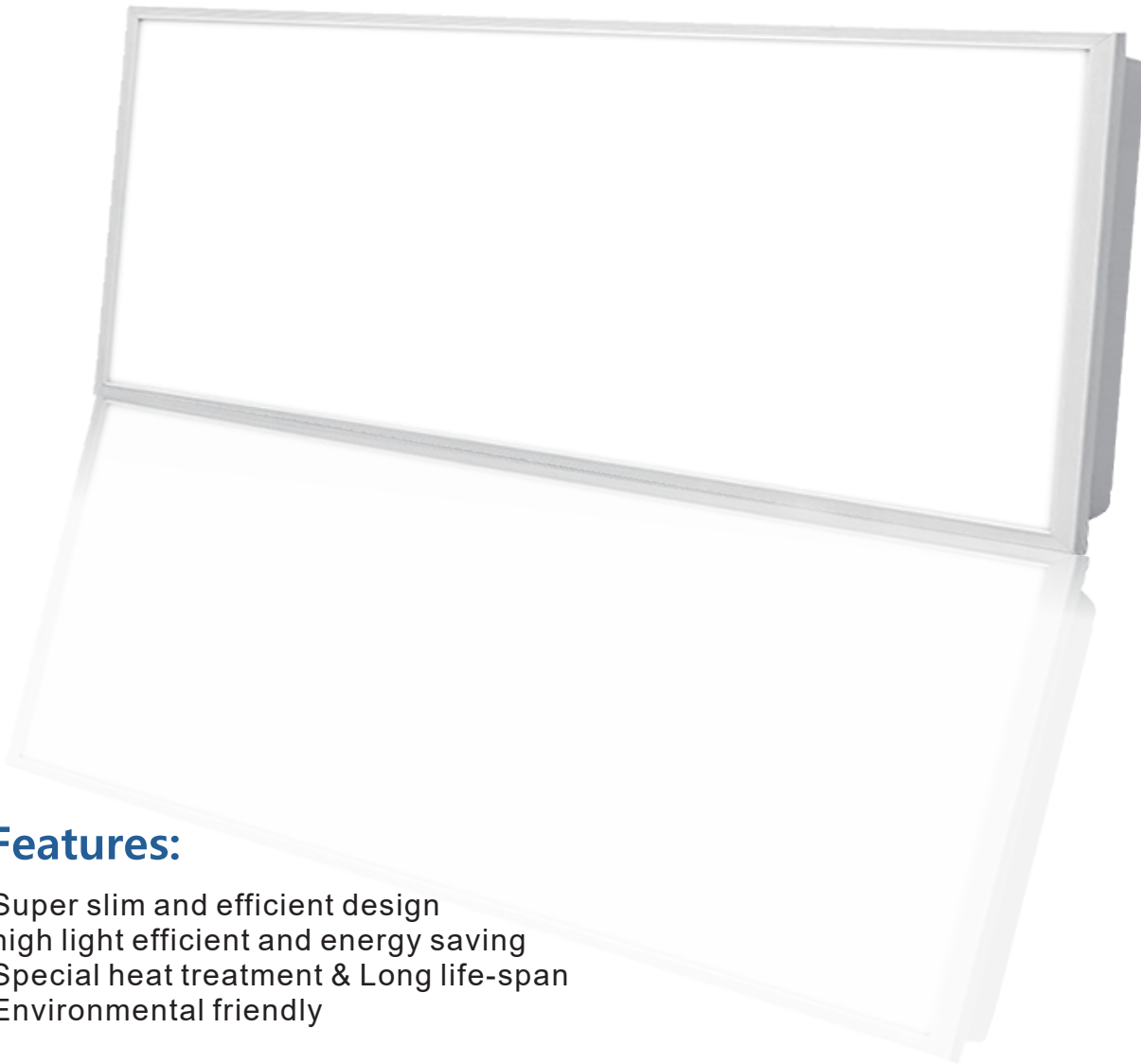

Features:

Super slim and efficient design
high light efficient and energy saving
Special heat treatment & Long life-span
Environmental friendly

Certificates



Dimension (Unit:mm)

Notes

- 1.All dimension units are millimeters
- 2.All dimension tolerance is ± 0.5 mm unless otherwise noted

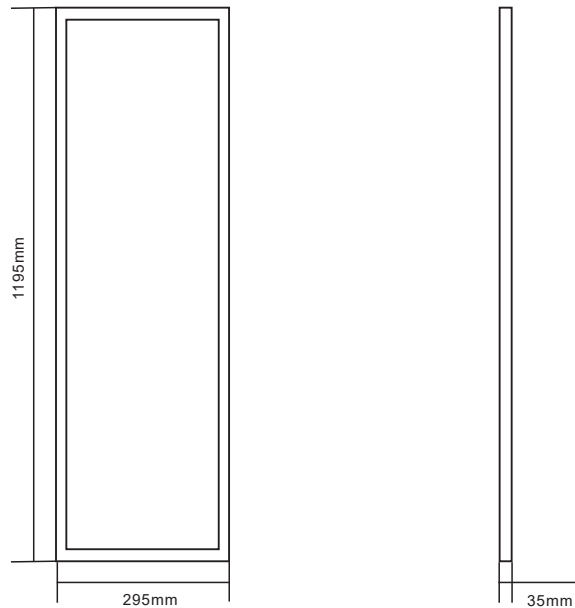

Technical Specification

300x1200mm

Item	ECO-PL1200x300-16W	ECO-PL1200x300-18W
Lumen	2240lm	2520lm
Size(mm)	295x1195x35	
Voltage	AC220-240V~50/60Hz	
Lumen Efficiency	140lm/W	
Beam Angle	120°	
PF	>0.9	
Sensor	Motion+Daylight	
CRI	Ra>80	
Material	AL+PC	

Application

This product is suitable for office, hall, family, hotel, conference room, factory or office, commercial use, residential or public facilities, school, hospital lights.



①	<p>⏻ : ON/OFF (turn on or turn off light)</p> <p>Ⓞ : Motion sensor ON/OFF(turn on or turn off motion sensor function)</p>	
②	<p>Brightness : Brightness dimming</p> <p>Min : Min brightness(10% brightness)</p> <p>⬇️ : Decrease brightness,each short press can decrease 10% brightness until min brightness</p> <p>⬆️ : Increase brightness,each short press can increase 10% brightness until max brightness</p> <p>Max : Max brightness(100% brightness)</p>	
③	<p>Standby Brightness : When motion sensor function is ON, light will dim to standby brightness after hold time with no motion detected</p>	<p>Off : Standby brightness is 0%</p> <p>10% : standby brightness is 10% of current brightness</p> <p>20% : standby brightness is 20% of current brightness</p> <p>30% : standby brightness is 30% of current brightness</p>
④	<p>Time Until Standby : When motion sensor function is ON, the time period when light dim to standby brightness</p>	<p>30Sec : 30 second</p> <p>3Min : 3 minutes</p> <p>10Min : 10 minutes</p>
⑤	<p>Ambient Light Sensor : When environment daylight is higher than photocell threshold,light will stay OFF</p>	<p>Off : Photocell function is turned off</p> <p>Dusk : Photocell threshold less than 50lux</p> <p>Night : Photocell threshold less than 20lux</p>
⑥	<p>Distance : Motion sensor detect distance range</p>	<p>Near : <3m</p> <p>Medium: 3-5m</p> <p>Far : 5-8m</p>

Tips:

<1>When long press motion sensor ON/OFF button for 2 second,once light blink means turn on motion sensor function, twice light blink means turn off motion sensor function.

<2>When short press buttons in ②③④⑤⑥ area,once light blink means succesful setting.

<3>Photocell threshold and detect distance might be affected by environment and installation,all above our data is just for your reference.

Remote instruction(bssed on lighting application)

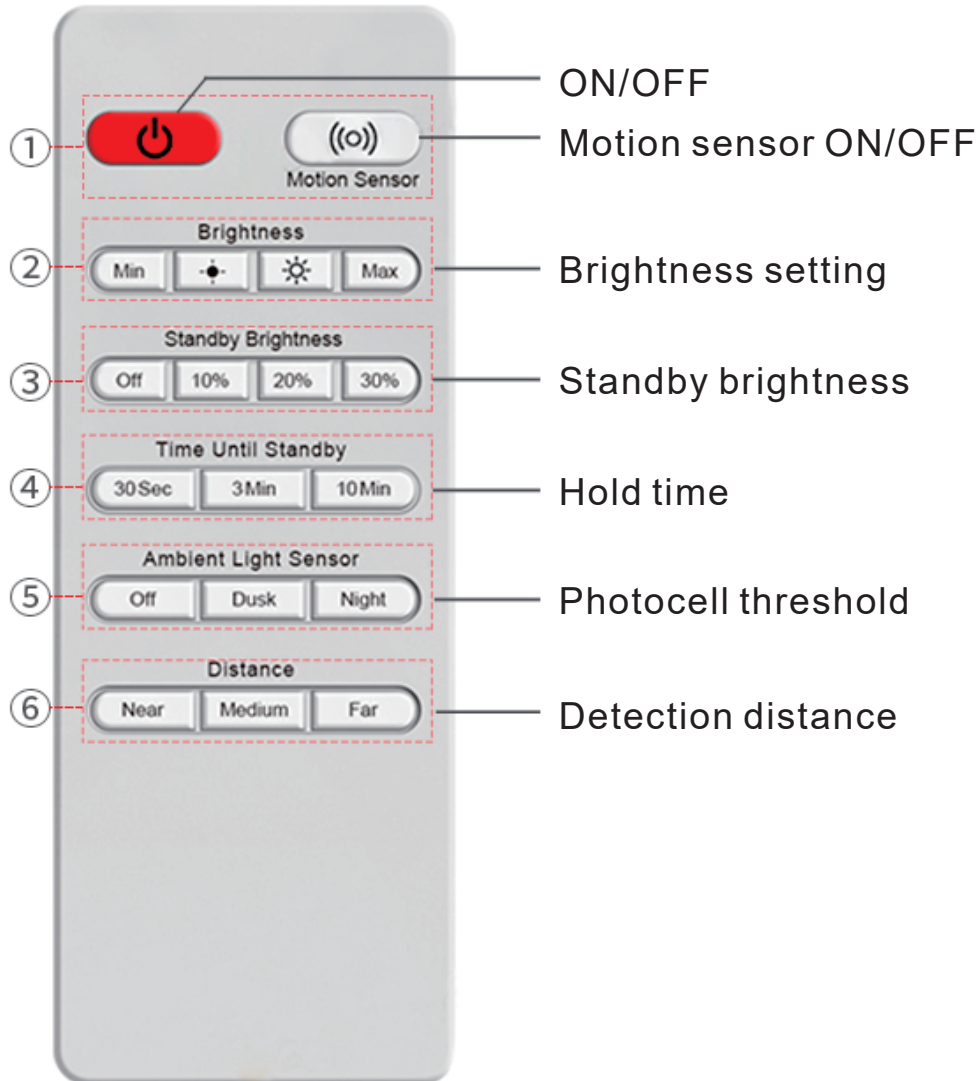

Safety / Information

1. Please make sure cut off the power before installation.
2. Please take care of water, electric shock and vibration.
3. Please use the panel with standard working voltage, any other voltage is not allowed;
4. Indoor use only;
5. Please read this manual carefully before using.



Packing information

Model NO:	Package	Size (mm)	QTY/PCS	Carton GW (KG)
ECO-PL1200x300-16/18W	Box size	1220*260*320	8	13.5

Installation instruction

1.Imbedding Installation:

Method.1

- 1.Take all accessories out of the bag,using spring accessories and lug with matched screws.
- 2.Fix lug with two screws as shown then fix spring accessories with screws in the holes of lug.
- 3.Assemble the remaining three springs as the same method then insert panel into ceiling.
Finish the installation.



Method.2

- 1.Cut an open hole on the ceiling where the panel light will be installed.
- 2.Imbeded the panel light inner the open hole.
- 3.Connecting the power cable to commercial power.

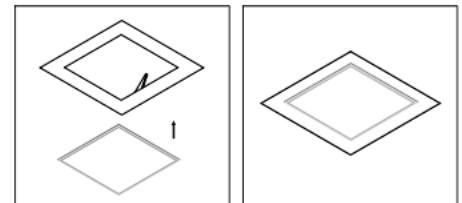

2.Surface Mounting Installation:

- 1.Assemble one “frame and two “b” frames with screws,one side isn’t sealed as shown (with the direction of the screw holes up) G
- 2.Fix the frame assembled in “1” on the ceiling,insert panel along two “b” frames, fix the remaining frame by screws,finish the installation.

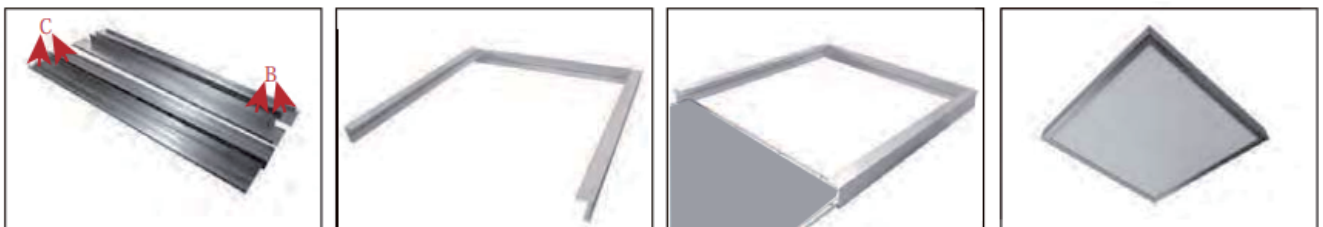

2.Suspending Installation:

- 1.Take all accessories out of the bag,using lug with matched screws together.
- 2.Screw off the bolt of the hanging rope.
- 3.Fix lug with two screws as shown then hang buckle buckled into the holes of lug (as the location figure out by red circle).
- 4.When four hanging buckles are buttoned,adjusting the hanging rope, making the panel lights in a Harizontal state.
- 5.Fix hanging rope with matched bolt in “1” to the ceiling,finish the installation.

